

GENERAL NOTES:

1. MAX. CAPACITY FOR EACH MAGAZINE IS 30,000 LBS.
2. MATERIAL CAN BE STORED UP TO 8" BELOW THE CEILING OF CONTAINER.

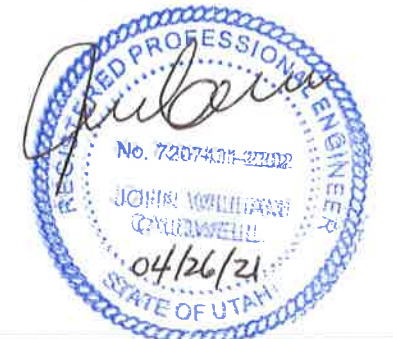

INTERLOCK DESCRIPTION	REVISIONS	REVISIONS	APPROVALS																																																																																													
	<table border="1" style="width: 100%; border-collapse: collapse;"> <thead> <tr> <th>NO</th> <th>DESCRIPTION</th> <th>DATE</th> <th>BY</th> <th>CHK</th> <th>ENG MGR</th> <th>NO</th> </tr> </thead> <tbody> <tr> <td>1</td> <td>INITIAL DESIGN</td> <td>04-08-21</td> <td>KB</td> <td>TH</td> <td>MM</td> <td>KB</td> </tr> <tr> <td> </td> <td> </td> <td> </td> <td> </td> <td> </td> <td> </td> <td> </td> </tr> <tr> <td> </td> <td> </td> <td> </td> <td> </td> <td> </td> <td> </td> <td> </td> </tr> <tr> <td> </td> <td> </td> <td> </td> <td> </td> <td> </td> <td> </td> <td> </td> </tr> </tbody> </table>	NO	DESCRIPTION	DATE	BY	CHK	ENG MGR	NO	1	INITIAL DESIGN	04-08-21	KB	TH	MM	KB																						<table border="1" style="width: 100%; border-collapse: collapse;"> <thead> <tr> <th>DESCRIPTION</th> <th>DATE</th> <th>BY</th> <th>CHK</th> <th>ENG MGR</th> </tr> </thead> <tbody> <tr> <td> </td> <td> </td> <td> </td> <td> </td> <td> </td> </tr> <tr> <td> </td> <td> </td> <td> </td> <td> </td> <td> </td> </tr> <tr> <td> </td> <td> </td> <td> </td> <td> </td> <td> </td> </tr> <tr> <td>AS BUILT</td> <td> </td> <td> </td> <td> </td> <td> </td> </tr> </tbody> </table>	DESCRIPTION	DATE	BY	CHK	ENG MGR																AS BUILT					<table border="1" style="width: 100%; border-collapse: collapse;"> <thead> <tr> <th></th> <th>BY</th> <th>DATE</th> </tr> </thead> <tbody> <tr> <td>DRUM CHECKED</td> <td>KB</td> <td>04-08-21</td> </tr> <tr> <td>ELEC</td> <td> </td> <td> </td> </tr> <tr> <td>MECH</td> <td> </td> <td> </td> </tr> <tr> <td>STRUCT</td> <td> </td> <td> </td> </tr> <tr> <td>PROJECT ENG</td> <td> </td> <td> </td> </tr> <tr> <td>ENGINEERING MGR</td> <td> </td> <td> </td> </tr> <tr> <td> </td> <td> </td> <td> </td> </tr> <tr> <td> </td> <td> </td> <td> </td> </tr> <tr> <td> </td> <td> </td> <td> </td> </tr> <tr> <td>AS BUILT</td> <td> </td> <td> </td> </tr> </tbody> </table>		BY	DATE	DRUM CHECKED	KB	04-08-21	ELEC			MECH			STRUCT			PROJECT ENG			ENGINEERING MGR												AS BUILT		
NO	DESCRIPTION	DATE	BY	CHK	ENG MGR	NO																																																																																										
1	INITIAL DESIGN	04-08-21	KB	TH	MM	KB																																																																																										
DESCRIPTION	DATE	BY	CHK	ENG MGR																																																																																												
AS BUILT																																																																																																
	BY	DATE																																																																																														
DRUM CHECKED	KB	04-08-21																																																																																														
ELEC																																																																																																
MECH																																																																																																
STRUCT																																																																																																
PROJECT ENG																																																																																																
ENGINEERING MGR																																																																																																
AS BUILT																																																																																																



Clean Harbors
 TITLE: UTAH ENVIRONMENTAL SERVICE CENTER
 EXPLOSIVES HANDLING AND STORAGE
 STORAGE LOCATIONS AND CAPACITIES

FOR: TOOELE SITE CAD NO.: DM852
 SCALE: JOB NO: CLEANHARBORS DWG NO: D-800-M-502 REV: 0

REGISTERED PROFESSIONAL ENGINEER
 DATE: _____

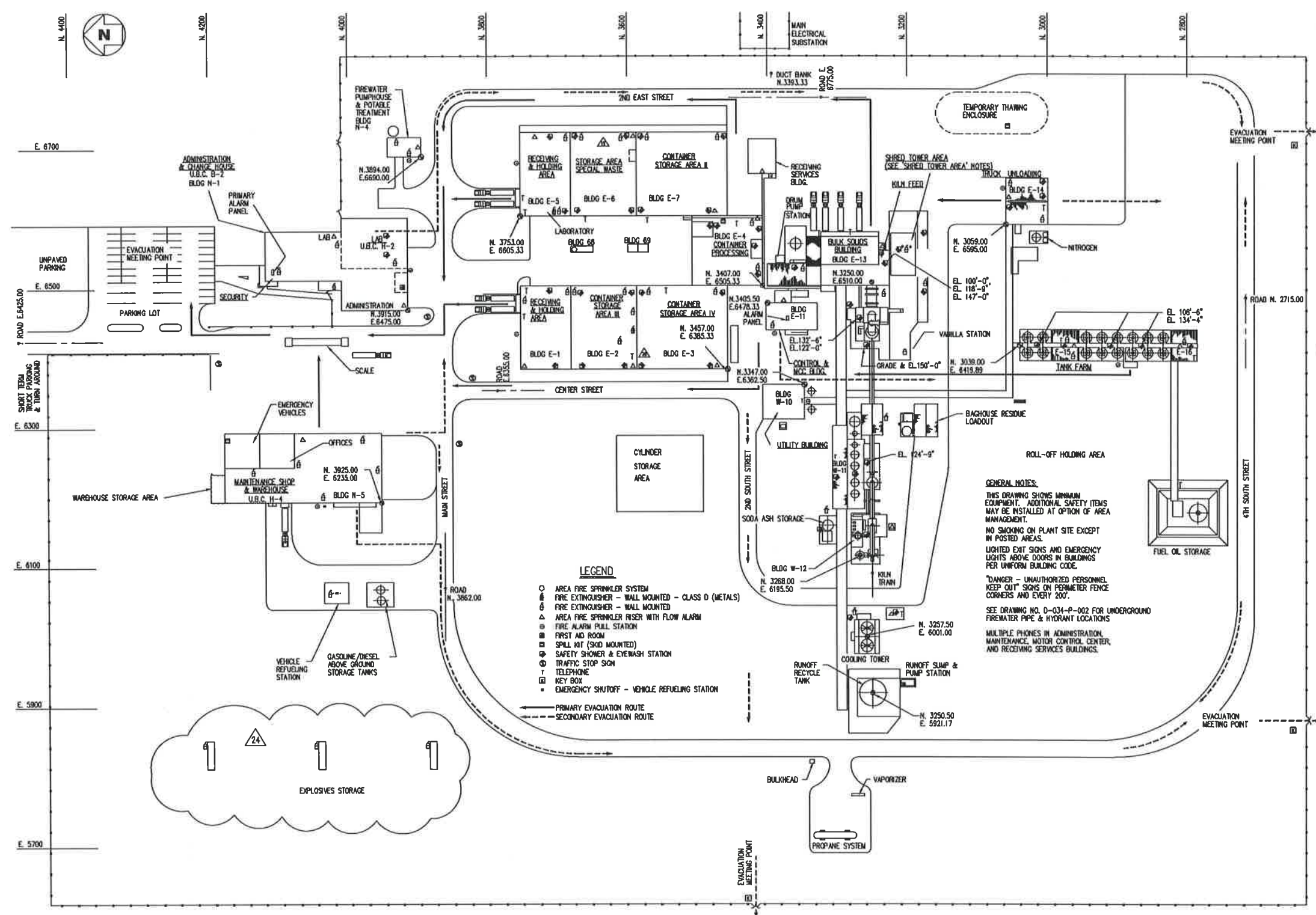

SHRED TOWER AREA NOTES:

1. THERE ARE 8 SAFETY SHOWERS IN THE SHRED TOWER AREA.

A. TWO (2) SAFETY SHOWERS @ 100'0"

B. ONE (1) SAFETY SHOWER @ 128'7"

C. ONE (1) SAFETY SHOWER @ 147'0"

D. ONE (1) SAFETY SHOWER @ 157'0"

E. ONE (1) SAFETY SHOWER @ 186'2"

2. THERE ARE 13 FIRE EXTINGUISHERS IN THE SHRED TOWER AREA.

A. TWO (2) FIRE EXTINGUISHERS @ 100'0"

B. ONE (1) FIRE EXTINGUISHER @ 118'7"

C. ONE (1) FIRE EXTINGUISHER @ 128'7"

D. ONE (1) FIRE EXTINGUISHER @ 137'9"

E. TWO (2) FIRE EXTINGUISHERS @ 147'0"

F. ONE (1) FIRE EXTINGUISHER @ 157'0"

G. FOUR (4) FIRE EXTINGUISHERS @ 186'2"

H. ONE (1) ADDITIONAL FIRE EXTINGUISHER BETWEEN EL. 137'9" AND EL. 147'0"

GENERAL NOTES:

THIS DRAWING SHOWS MINIMUM EQUIPMENT. ADDITIONAL SAFETY ITEMS MAY BE INSTALLED AT OPTION OF AREA MANAGEMENT.

NO SMOKING ON PLANT SITE EXCEPT IN POSTED AREAS.

LIGHTED EXIT SIGNS AND EMERGENCY LIGHTS ABOVE DOORS IN BUILDINGS PER UNIFORM BUILDING CODE.

"DANGER - UNAUTHORIZED PERSONNEL KEEP OUT" SIGNS ON PERIMETER FENCE CORNERS AND EVERY 200'.

SEE DRAWING NO. D-034-P-002 FOR UNDERGROUND FIREWATER PIPE & HYDRANT LOCATIONS.

MULTIPLE PHONES IN ADMINISTRATION, MAINTENANCE, MOTOR CONTROL CENTER, AND RECEIVING SERVICES BUILDINGS.

- LEGEND**
- AREA FIRE SPRINKLER SYSTEM
 - ⊕ FIRE EXTINGUISHER - WALL MOUNTED - CLASS D (METALS)
 - ⊕ FIRE EXTINGUISHER - WALL MOUNTED
 - ⊕ AREA FIRE SPRINKLER RISER WITH FLOW ALARM
 - ⊕ FIRE ALARM PULL STATION
 - ⊕ FIRST AID ROOM
 - ⊕ SPILL KIT (SKID MOUNTED)
 - ⊕ SAFETY SHOWER & EYEWASH STATION
 - ⊕ TRAFFIC STOP SIGN
 - ⊕ TELEPHONE
 - ⊕ KEY BOX
 - ⊕ EMERGENCY SHUTOFF - VEHICLE REFUELING STATION
- PRIMARY EVACUATION ROUTE
 - - - SECONDARY EVACUATION ROUTE

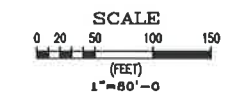

PLOT PLAN

REFERENCE DRAWINGS	
DRAWING NO	TITLE

REVISIONS						
NO	DESCRIPTION	DATE	BY	CHK	ENG MGR	
1	ADDED SHRED TOWER AREA AND SAFETY EQUIPMENT	03-12-21	KB	TH	SS	KB
2	AND ADDED SHRED TOWER AREA NOTES					
3	ADDED EXPLOSIVES MAGAZINES	04-06-21	KB	TH	MM	KB
4	UPDATE DWG. FOR CYLINDER STATION, OTHER	06-19-03	KL			
5	CHANGES					

REVISIONS						
NO	DESCRIPTION	DATE	BY	CHK	ENG MGR	
1	ADDED EYEWASH/SAFETY SHOWER	04-12-2011	LCC			
2	ADDED E68 & E69 BLDGS.	05-06-16	MM	LB		
3	REVISED E1-E7 SAFETY EQUIPMENT LOCATIONS	09-08-16	MM	CP		
4	MOVE TELEPHONE IN E2	02-14-20	JWR	TH	JWR	
5	MOVE BLDG 68, 69, ADD BLDG 70, 71, ADD TO LGND	03-03-21	KB	MM	TH	KB

APPROVALS		
	BY	DATE
DRAWN		
CHECKED		
ELEC		
MECH		
STRUCT		
PROJECT ENG		
ENGINEERING MGR		
AS BUILT		

REGISTERED PROFESSIONAL ENGINEER
DATE:



TITLE: **UTAH ENVIRONMENTAL SERVICE CENTER INCINERATION PLANT FOR INDUSTRIAL WASTES SAFETY EQUIPMENT PLAN**

FOR: TOOLEE SITE CAD NO. NK969

SCALE: 1"=80'-0" JOB NO. APTUS DWG NO. D-034-M-005 REV. 24



MAIN ELECTRICAL SUBSTATION

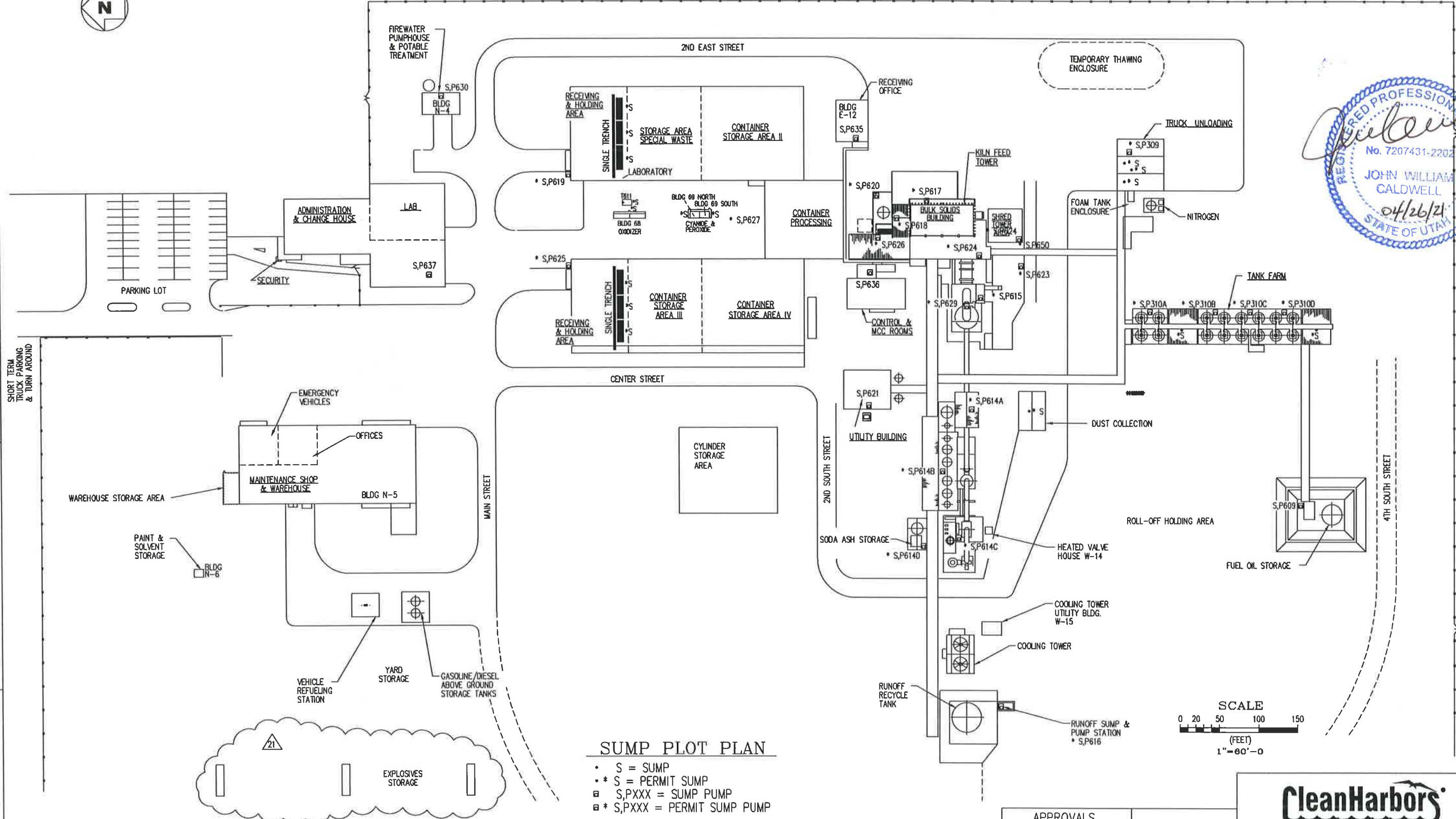

SUMP PLOT PLAN

- S = SUMP
- * S = PERMIT SUMP
- ◻ S,PXXX = SUMP PUMP
- ◻ * S,PXXX = PERMIT SUMP PUMP

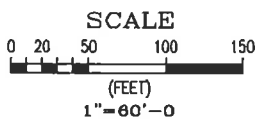

REFERENCE DRAWINGS	
DRAWING NO	TITLE

REVISIONS						
NO	DESCRIPTION	DATE	BY	CHK	ENG MGR	
15	RELOCATE T611, AS BUILT BLDGS 68 & 69	10-5-2011	TJK		TJK	
16	ADD REF NORTH & SOUTH COMPARTMENTS BLDG 69	03-28-12	TJK		TJK	
17	MOVE EDUCT, 68 & 69, ADD BLDG E-8, 70 & 71	10-25-20	KB	TH	SS	KB
18	MOVE BLDG 68 & 69, ADD BLDG 70 & 71	03-03-21	KB	TH	MM	KB
19	ADDED SHRED TOWER AREA, ADD S,P650	03-04-21	KB	TH	MM	KB

REVISIONS						
NO	DESCRIPTION	DATE	BY	CHK	ENG MGR	
1	ADDED EXPLOSIVES MAGAZINES	04-06-21	KB	TH	MM	KB
2	REMOVAL OF SUMP TRENCHES	2-17-00	GVC			
3	ADDED CYLINDER STORAGE, OTHER CHANGES	6-9-03	KL			
4	ADDED SUMP	02-22-08	KL			
5	ADDED T611, BLDG 68 & 69 WITH SUMPS	40CT10	BAD	WC	BAD	

APPROVALS		
	BY	DATE
DRAWN		
CHECKED		
ELEC		
MECH		
STRUCT		
PROJECT ENG		
ENGINEERING MGR		
AS BUILT		

REGISTERED PROFESSIONAL ENGINEER
DATE: _____

Clean Harbors
ARAGONITE LLC

THIS DRAWING IS THE PROPERTY OF CLEAN HARBORS ARAGONITE LLC. ANY INFORMATION CONTAINED HEREIN SHALL NOT BE COPIED OR USED WITHOUT WRITTEN PERMISSION OF OWNER.

TITLE: UTAH ENVIRONMENTAL SERVICE CENTER INCINERATION PLANT FOR INDUSTRIAL WASTES SUMP AND SUMP PUMP LOCATION

FOR TOOELE SITE	CAO NO. MA065H
SCALE 1"= 60'-0"	JOB NO.
DATE: _____	APTUS DWG NO. D-034-M-002-SP 21

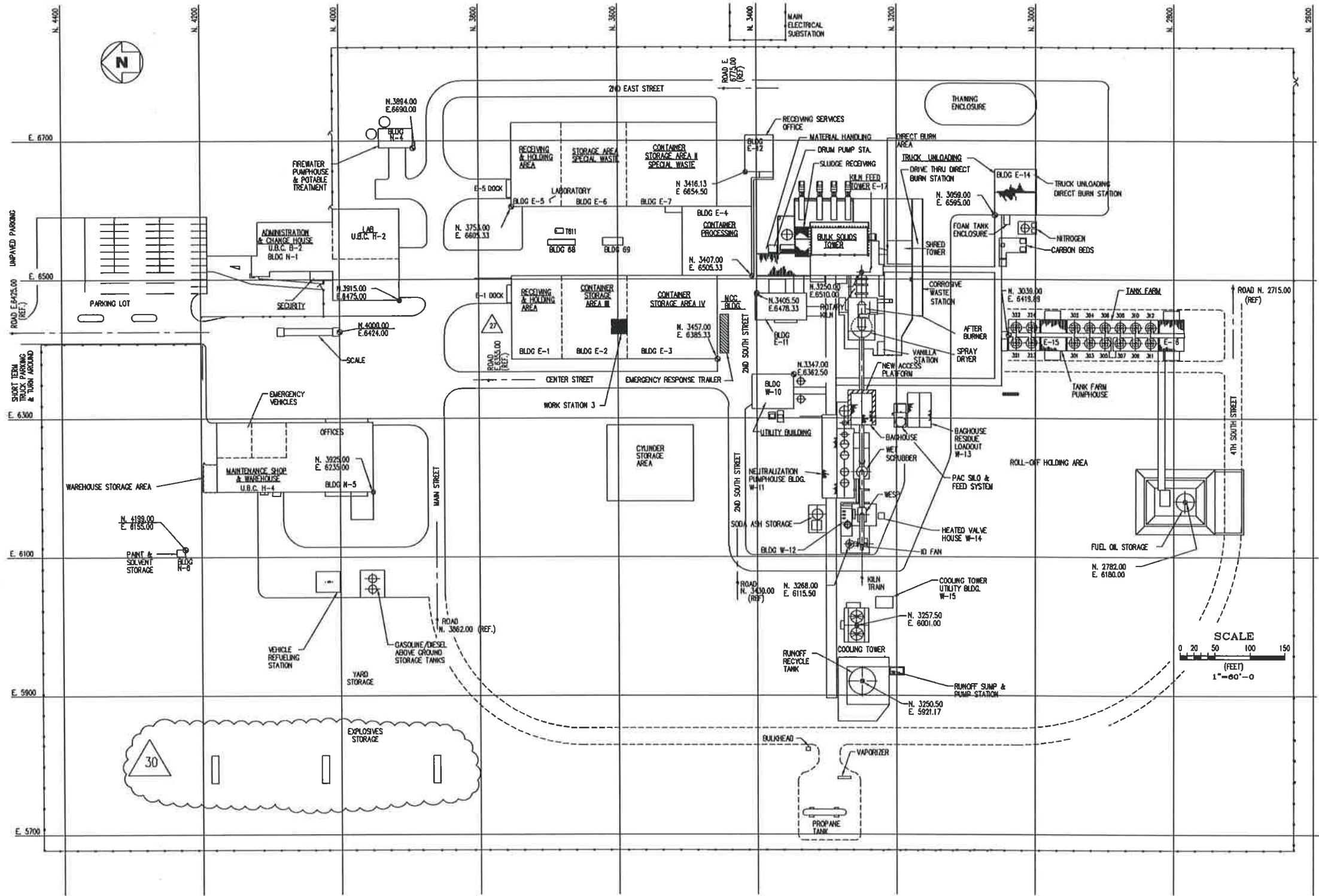

PLOT PLAN

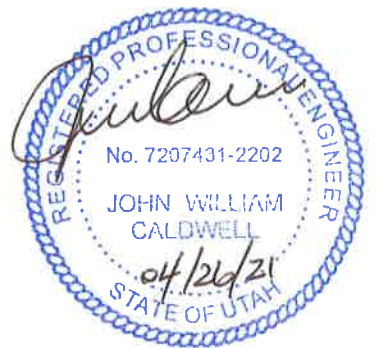

NOTES:

REVISIONS

REVISIONS

NO	DESCRIPTION	DATE	BY	CHK	ENG MGR
1	DELETE FUTURE BLDGS E-8 & E-9	04/16/12	TJK		
2	ADDED NEW WATER TANK	12-6-17	GBS		
3	MOVE EDUCY STA., ADD CONEX, MV. 68 & 69	10-05-20	KB	TH	MM
4	ADD E-8 BLDG, ADD 70 & 71 BLDG				
5	MOVE BLDG 68, 69, ADD BLDG 70, 71	03-03-21	KB	NM	TH

NO	DESCRIPTION	DATE	BY	CHK	ENG MGR
1	ADDED SHRED TOWER AREA	03-04-21	KB	TH	NM
2	ADDED EXPLOSIVES MAGAZINES	04-06-21	KB	TH	NM
3	ADDED CONTAINMENT TANK T611	40CT10	BAD	WC	BAD
4	RELOCATE T611, AS BUILT BLDGS 68 & 69	10-05-11	TJK		TJK
5	ADD BLDG 69 N & S; DELETE ROLLOFF PAD	03-22-12	TJK		

APPROVALS

	BY	DATE
DRAWN		
CHECKED	CRM	12-31-98
ELEC		
MECH		
STRUCT		
PROJECT ENG		
ENGINEERING MGR		
AS BUILT		

REGISTERED PROFESSIONAL ENGINEER
DATE: _____

CleanHarbors
ARAGONITE LLC
THIS DRAWING IS THE PROPERTY OF CLEAN HARBORS, ARAGONITE, LLC
ANY REPRODUCTION, COPIING, OR USE WITHOUT WRITTEN PERMISSION OF OWNER.

TITLE
UTAH ENVIRONMENTAL SERVICE CENTER
INCINERATION PLANT FOR INDUSTRIAL WASTES
PLOT PLAN

FOR TOOELE SITE	CAD NO.	MK409AK
SCALE AS NOTED	JOB NO.	
	APTUS DWG NO.	D-034-M-002
	REV	30

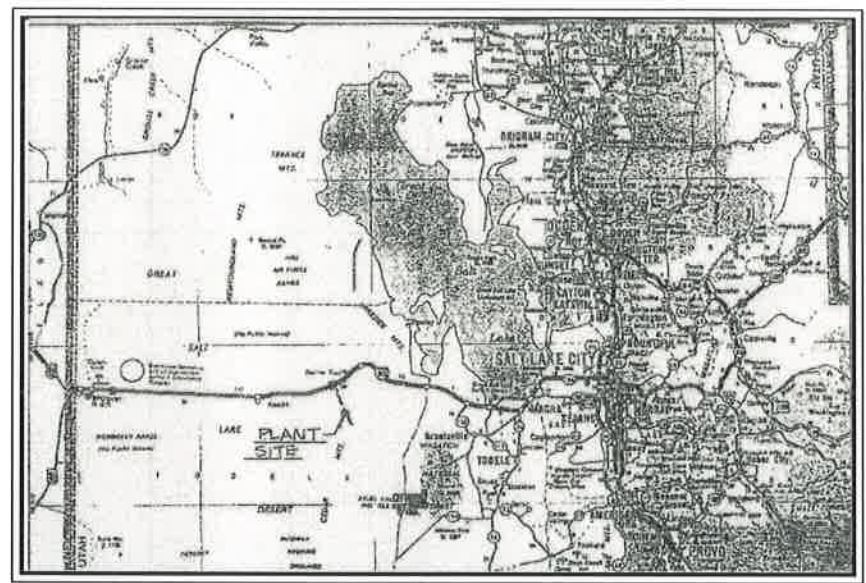
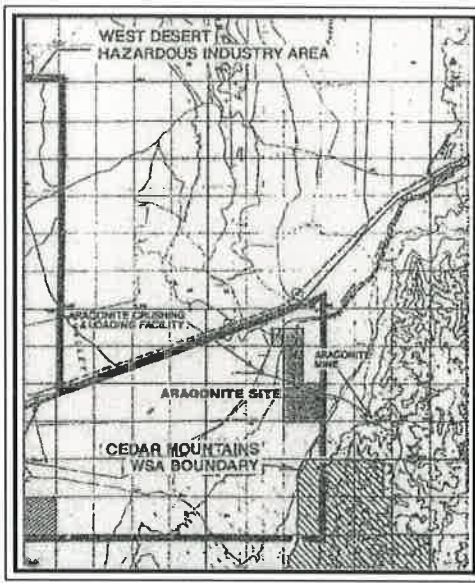

LOCAL AREA

HIGHWAY MAP

NOTES:

- TOPOGRAPHY SHOWN WAS TAKEN FROM U.S.G.S. QUADRANGLE "HASTINGS PASS, UTAH, 1973".
- NOT IN 100 YEAR FLOOD PLAIN. HIGHEST RECORDED LEVEL OF GREAT SALT LAKE, ELEVATION 4,217 FEET MEAN SEA LEVEL.
- BASIS OF BEARINGS IS EAST FROM NORTHWEST CORNER OF SECTION 16, T.1 S., R. 10 W., S.L.B.&M. TO THE NORTHEAST CORNER OF SAID SECTION 16.
- BENCHMARK IS APPROXIMATE ASSUMED U.S.G.S. DATUM FROM NORTHWEST CORNER OF SAID SECTION 16.
- PLANT ELEVATION DATUM 100'-0" EQUALS U.S.G.S. ELEVATION DATUM 4,682'-0".
- FOR SURVEY CONTROL MONUMENT DATA, SEE R&M DRAWING NUMBER 8936-1.
- LAND DESCRIPTION:

A TRACT OF LAND LYING IN TOOELE COUNTY, STATE OF UTAH, SECTION 16, TOWNSHIP ONE (1) SOUTH, RANGE TEN WEST, SALT LAKE MERIDIAN AND BASE LINE, CONTAINING 640 ACRES MORE OR LESS, ACCORDING TO THE UNITED STATES SURVEY.

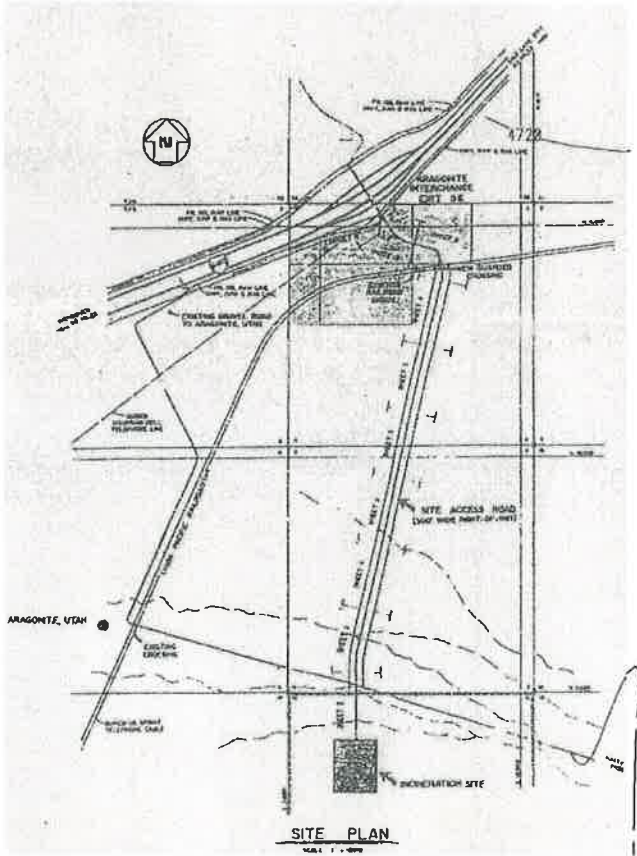
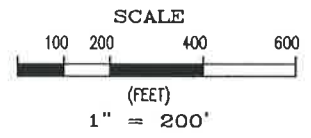

SITE PLAN

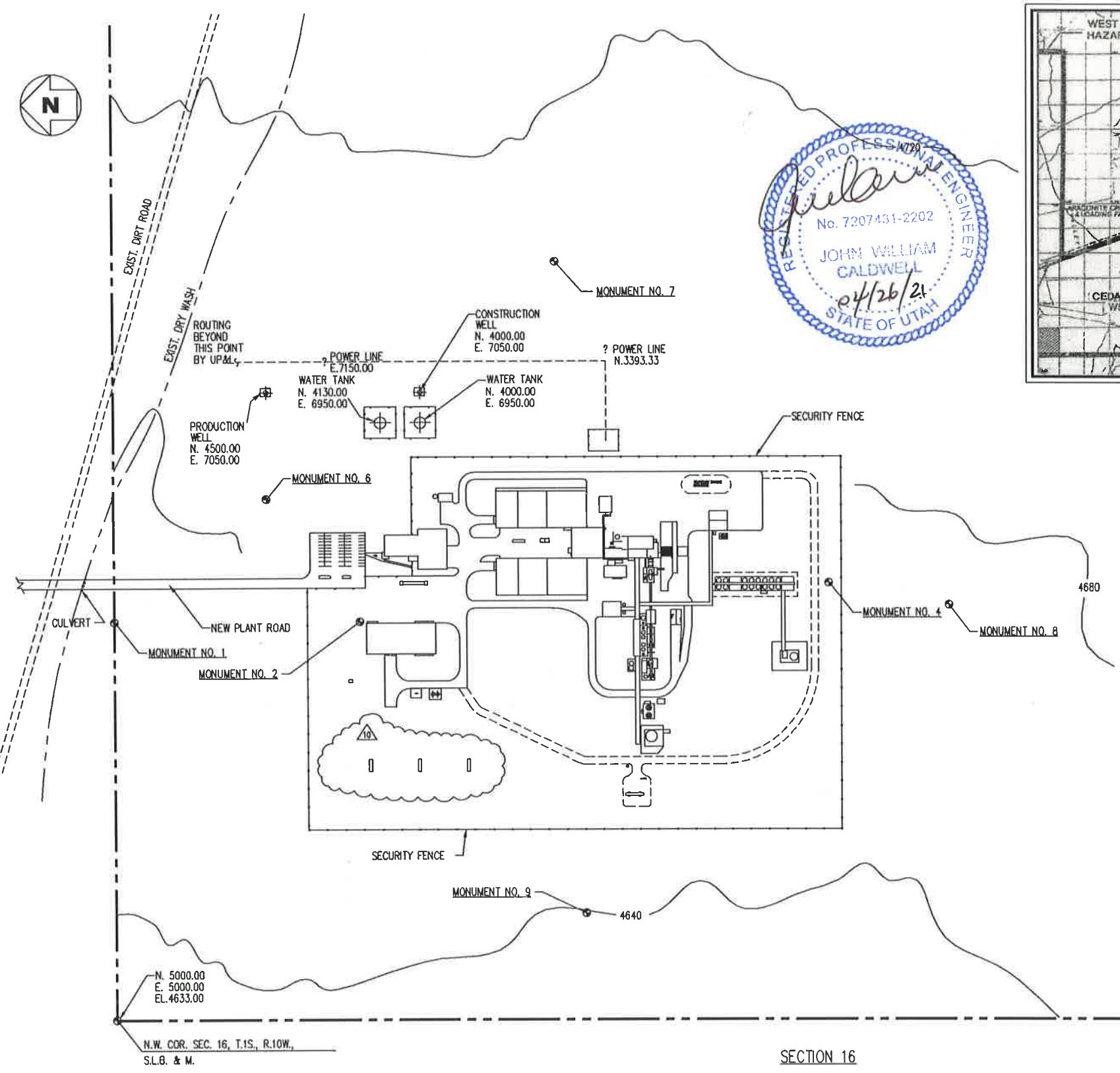

SECTION 16

S.W. COR. SEC. 16, T.1S., R.10W., S.L.B. & M.

REVISIONS									
NO	DESCRIPTION	DATE	BY	CHK	ELEC	MECH	STR	PROJ MGR	
1	APPROVED FOR CONSTRUCTION	7-21-89							
2	ADDED MONUMENTS	1-5-90	RLJ					JV	
3	AS BUILT	07-01-91	DCP						
4	ADDED NEW BUILDINGS	05-06-16	MM						
5	ADDED NEW WATER TANK	12-6-17	GBS						
6	ADD NEW RAW WTR TK/RMV POT WTR TK	02-15-19	JMR					JWR	
7	CLASS 4 MAGAZINE STORAGE								
8	ADD SHRED TWR, MOVE EDUCT STA.	10-05-20	KB	TH				KB	

REVISIONS									
NO	DESCRIPTION	DATE	BY	CHK	ELEC	MECH	STR	PROJ MGR	
1	MOVE BLDG 68 & 69	03-03-21	KB	TH				KB	
2	ADD SHRED TOWER	03-04-21	KB	TH				KB	
3	ADD EXPLOSIVES STORAGE	04-05-21	KB	TH				KB	

REFERENCE DRAWINGS	
DRAWING NO	TITLE
D-034-M-002	PLANT PLOT PLAN
8936-1 (R&M)	OFF SITE FACILITIES

REGISTERED PROFESSIONAL ENGINEER
DATE: _____

APPROVALS		CURRENT DRAWING STATUS	
BY	DATE	BY	DATE
		PRELIMINARY OR PLANNING	
		APPROVED FOR FINAL DESIGN	
		APPROVED FOR QUOTE/PURCH	
		APPROVED FOR CONSTRUCTION	
		AS-BUILT	



ARAGONITE LLC
THIS DRAWING IS THE PROPERTY OF CLEAN HARBORS ARAGONITE LLC. ANY INFORMATION CONTAINED HEREON MAY NOT BE COPIED OR USED WITHOUT WRITTEN PERMISSION OF OWNER.

UTAH ENVIRONMENTAL SERVICE CENTER
INCINERATION PLANT FOR INDUSTRIAL WASTES
SITE PLAN

FOR TOOELE SITE		CAD DISK FILE	
SCALE 1" = 200'	JOB NO	APTUS DWG NO	MK966
	ENG. DWG NO	D-034-M-001	REV 10